

— Avoid infection in the museum

So that all guests have a pleasant stay with us, please note the following guidelines:

- ▷ We are sorry but **acutely ill persons** are not allowed to visit our museum!
- ▷ Please follow the **recommendations** of the Robert Koch Institute (RKI):



Keep your
distance
1.5 meters



Wash your
hands
thoroughly



Avoid
shaking
hands



Cough and sneeze
into a tissue
or the crook of
your arm

- ▷ Please wear a **mouth-nose mask**. If you don't have one, you can buy a washable mask made of cotton for 6,00 € at our cash desks.
- ▷ In the staircases the **walking directions** are marked. Please follow these guidelines.
- ▷ If you need to use an **elevator**, follow the instructions given there.
- ▷ For a tour through the exhibition, you can use the **marks on the floor (guidance system for the blind)** to orientate yourself, so keep the direction in the exhibition.
- ▷ We do not borrow our multimedia guide devices. You can use the audio tour to the 'highlights' with your own smartphone:
mmg.historisches-museum-frankfurt.de



— Avoid infection in the museum

- ▷ Open **doors and electronic door openers** as contactless as possible. If you need help, the public attendants and guards on all levels of the exhibition building will help you.
- ▷ If you touch **handrails, handles or buttons on showcases**, please use a handkerchief or your clothing sleeve.
- ▷ **Media stations** have been configured so that they do not need to be operated. At a few stations you can operate the touch surface yourself, they are regularly disinfected.
- ▷ If you need help or have any questions, please contact the **public attendants and guards**.
- ▷ **Accessible areas of the museum:**

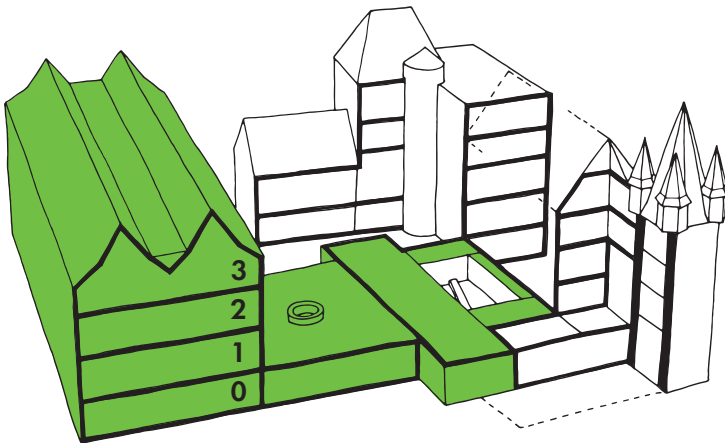

Unfortunately still closed at the moment:

- Museumscafé at level 0
- Exhibitions: Staufer, Toll Tower, Collectors & Donors
- Frankfurt Young Museum

We wish you a pleasant stay!

